

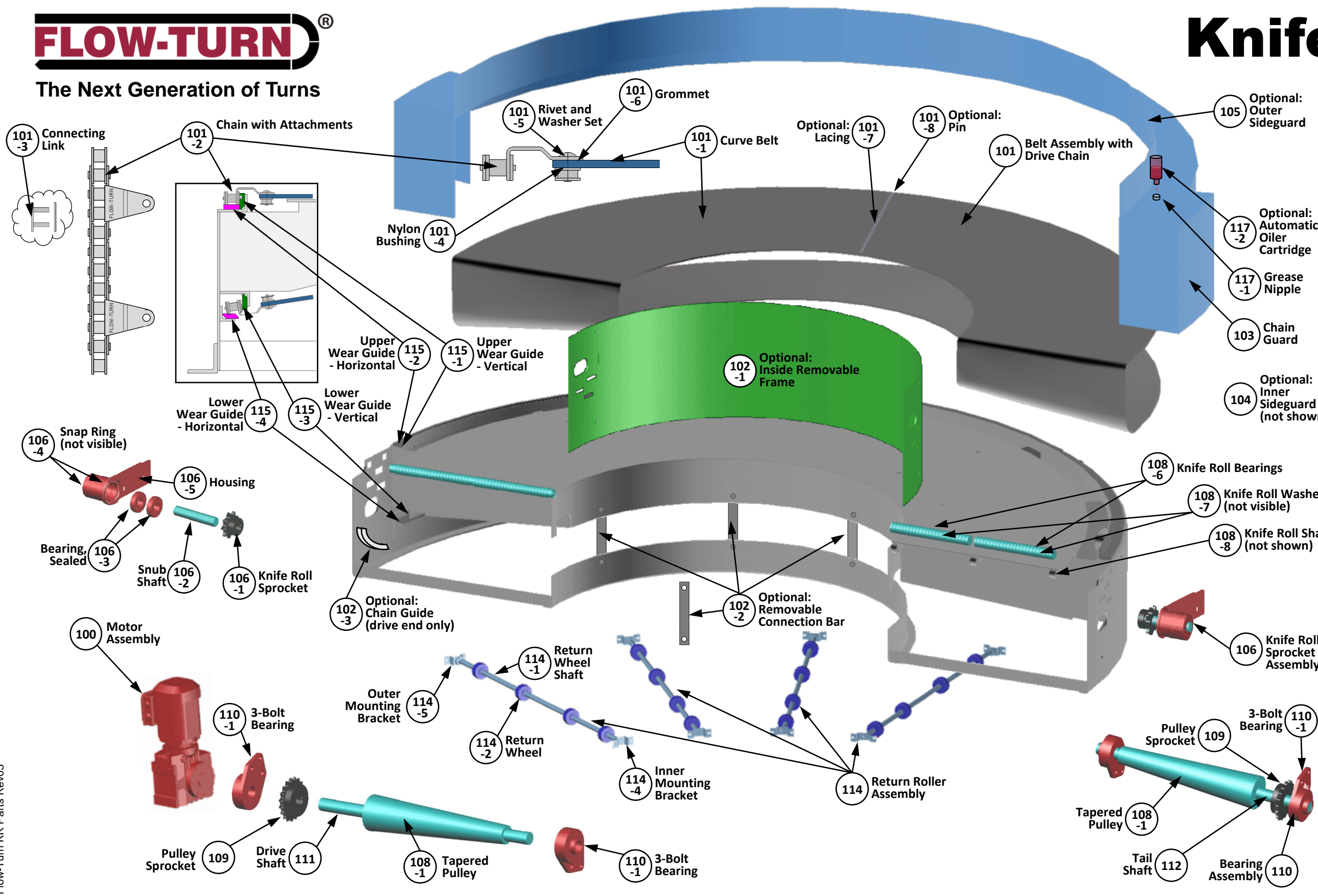

The Next Generation of Turns

Knife Roll-Turn

Illustrated Parts List



Short Part #	Item Description
100	Motor Assembly
100-1	Motor/Gearmotor
100-2	Reducer
100-3	Torque Arm
100-4	Motor Bracket
101	Belt Assembly with Drive Chain
101-1	Curve Belt
101-2	Chain with Attachments
101-3	Connecting Link
101-4	Nylon Bushing
101-5	Rivet and Washer Set
101-6	Grommets
101-7	Lacing
101-8	Pin
102	Frame and Bed Components
102-1	Inside Removable Frame
102-2	Removable Connection Bar
102-3	Chain Guide
103	Chain Guard
104	Inner Sideguard
105	Outer Sideguard
106	Knife Roll Sprocket Assembly
106-1	Knife Roll Sprocket
106-2	Snub Shaft
106-3	Bearing, Sealed
106-4	Snap Ring
106-5	Housing
108	Pulleys and End Rolls
108-1	Tapered Pulley
108-6	Knife Roll Bearing
108-7	Knife Roll Washer
108-8	Knife Roll Shaft
109	Pulley Sprocket
110	Bearing Assembly
110-1	3-Bolt Bearing
110-2	Bearing Cover
111	Drive Shaft
112	Tail Shaft
114	Return Roller Assembly
114-1	Return Wheel Shaft
114-2	Return Wheel
114-4	Inner Mounting Bracket
114-5	Outer Mounting Bracket
115	Wear Guide Kit
115-1	Upper Wear Guide - Vertical
115-2	Upper Wear Guide - Horizontal
115-3	Lower Wear Guide - Vertical
115-4	Lower Wear Guide - Horizontal
117	Lubrication
117-1	Grease Nipple
117-2	Automatic Oiler Cartridge

Flow-Turn KR Parts Rev03

© FLOW-TURN Inc. subject to modification



1050 Commerce Avenue, Union, NJ 07083

Phone: (908) 687 - 3225
 Fax: (908) 687 - 1715
 Email: sales@flow-turn.com
 www.flow-turn.com

*Custom design is a FLOW-TURN specialty.
 We manufacture to rigid specifications and provide answers to unusual requirements.*



1050 Commerce Avenue, Union, NJ 07083

Phone: (908) 687 - 3225
 Fax: (908) 687 - 1715
 Email: sales@flow-turn.com
 www.flow-turn.com

*Custom design is a FLOW-TURN specialty.
 We manufacture to rigid specifications and provide answers to unusual requirements.*